

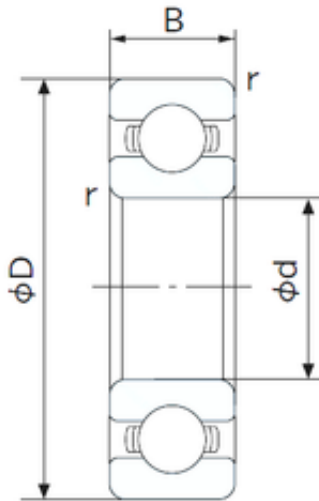

# SRS PRECISION AXLE CORP.



6206 2RS 6207 2RS 6208 2RS 6209 2RS- O&Kai  
Z1V1 Z2V2 Z3V3 ISO Deep Groove Ball Bearing  
SKF NSK NTN NACHI Koyo FAG OEM

Bearing No. 6206

6206 Bearing 2D drawings and 3D CAD models

Size	30x62x16 mm
Bore Diameter	30 mm
Outer Diameter	62 mm
Width	16 mm
d	30 mm
D	62 mm
B	16 mm
C	16 mm
r min.	1 mm
da min.	36 mm
Da max.	56 mm
ra max.	1.0 mm
Weight	0.199 Kg
Basic dynamic load rating (C)	19,5 kN
Basic static load rating (C0)	11,3 kN
(Grease) Lubrication Speed	10000 r/min
Category	Single Row Ball Bearings
Inventory	0.0
Manufacturer Name	NACHI
Minimum Buy Quantity	N/A
Weight / Kilogram	0
Product Group	B00308
Enclosure	Open
Precision Class	ABEC 1   ISO P0



## SRS PRECISION AXLE CORP.

Maximum Capacity / Filling Slot	No
Rolling Element	Ball Bearing
Snap Ring	No
Internal Special Features	No
Cage Material	Steel
Internal Clearance	C0-Medium
Inch - Metric	Metric
Long Description	30MM Bore; 62MM Outside Diameter; 16MM Outer Race Width; Open; Ball Bearing; ABEC 1   ISO P0; No Filling Slot; No Snap Ring; No Internal Special Features; C0-Medium Internal Clearance; Steel Cage
Other Features	Deep Groove
Category	Single Row Ball Bearing
UNSPSC	31171504
Harmonized Tariff Code	8482.10.50.68
Noun	Bearing
Keyword String	Ball
Manufacturer URL	<a href="http://www.nachiamerica.com">http://www.nachiamerica.com</a>
Weight / LBS	0.439
Inner Race Width	0 Inch   0 Millimeter
Outside Diameter	2.441 Inch   62 Millimeter
Outer Race Width	0.63 Inch   16 Millimeter
Bore	1.181 Inch   30 Millimeter
Bore Type	Cylindrical Bore
Configuration	Single Row
Bore Size	30 mm
Width	16 mm
Fillet Radius/Chamfer	1 mm



## SRS PRECISION AXLE CORP.

Dynamic Load Rating	19,500 N
Static Load Rating	11,300 N
Limiting Speed - Grease	11,000 rpm
Limiting Speed - Oil	13,000 rpm
Factor $f_0$	13.9
Radial Clearance	0.005 to 0.020 mm
da (min)	36 mm
Da (max)	56 mm
ra (max)	1 mm